

User's Manual

Cold & Compression
Therapy System



MedNet EC-REP GmbH,
Borkstrasse 10.48163 Münster. Germany

Equi Recover
Opperduit 360
2941AR Lekkerkerk
Netherlands

Table of Contents

| | |
|---------------------------------|----|
| Warning and Cautions..... | 01 |
| Indications for Use..... | 02 |
| Contraindications..... | 02 |
| Specifications..... | 03 |
| Environment Requirements..... | 03 |
| Compositions..... | 04 |
| Operating the System..... | 05 |
| Troubleshooting..... | 07 |
| Other Instructions..... | 09 |
| Warranty Information..... | 09 |
| Cuffs..... | 10 |
| Standard Compliance..... | 12 |
| Software Version..... | 12 |
| Symbol Index..... | 12 |
| Warranty Registration Card..... | 13 |
| Contact information..... | 14 |

Warning and Cautions

1. Please read the instruction manual carefully before use.
2. Do not drop or press this product.
3. Do not dis assemble or destroy this product.
4. Use only the cold cuff and power adapter supplied by the manufacturer.
5. The applied part is the cuff of different body parts, when using, a medical isolation pad should be placed between the cold cuff and the skin.
6. Do not use if the electrical parts are damaged/leaked.
7. Be careful not to trip over the systems power cords or hose.
8. To avoid damage, do not operate the system if water is not filled in the cooler.
9. The product is not refrigeration equipment, need to add ice water or ice cubes to adjust the temperature;
10. To avoid risk of electrical shock, always turn off the system and disconnect the power line cord from its electrical outlet when not in use or before adding or emptying ice and water.
11. Follow the treatment recommendations of your health care practitioner for the use of this product; improper or prolonged use of the product could result in tissue damage.
12. This product is under certain pressure when used. It is forbidden to use on any **wound**.
13. When using this product, the cooler and the cuff should be placed at the same level, and the height difference between the two should not be more than 40CM;
14. Do not use this product when water leaks.
15. Monitor the skin condition of affected area for any burning, itching, increased stinging, or pain. If any of these happens, or any changes in skin appearance occur such as blisters, increased redness or discoloration, users should stop using and consult a physician.
16. Children, the elderly and those who have cognitive disabilities or communication barriers cannot use the product alone without supervision.
17. If device malfunctions or you feel uncomfortable, take off the cuff immediately and disconnect from power source.

Indications for Use

It is intended to be used for temporary reduction of swelling and pain after surgery or injury. It is intended to be used by or on the order of licensed healthcare professionals in hospitals, outpatient clinics, athletic training or home settings.

Contraindications

DO NOT USE THE PRODUCT **BEFORE** CONSULTING A DOCTOR IF ANY OF THE FOLLOWING APPLIES:

1. Patients with Raynaud disease.
2. Acute, unstable (untreated) fracture.
3. Who have rheumatoid arthritis in the affected region.
4. Who have open wounds, or localized unstable skin condition.
5. Who are intolerant to cold compress or have cold hypersensitivity.
6. The pregnant, patients with hypertension, extreme low blood pressure or circulation disorders.
7. Who have vascular diseases such as prior frostbite, diabetes, arteriosclerosis or ischemia.
8. Who have hematological dyscrasias which affect thrombosis such as paroxysmal cold hemoglobinuria, globulinemia, sickle-cell disease or serum cold agglutinins.
9. Who are in the acute stages of inflammatory phlebitis in the affected region.

Specifications

Adaptor output: 12V/2A
Adaptor Input: 100-240d 50/60Hz
Pressure level: Low/Medium/High
Noise: below 55 decibels
Capacity: maximum 3.6L
Temperature level: 0°C-25°C
Weight: 1.78kgs empty

Environment Requirements

Operating:
Temperature : 5°C 40°C
Relative humidity : 10% 90%
Atmospheric pressure : 700hPa 1060hPa

Transport & Storage:
Temperature: -25°C-55°C
Relative humidity: 10% 90%
Atmospheric pressure: 700-1060hPa

Compositions



Cooler



Connector Hose



Cuff



Carry bag



User's Manual



Adapter



Drain Gadget

Operating the System

1. Push to open the cooler lid; add water to fill-line labeled inside the cooler (Do not fill water lower than the fill-line); add ice into cooler according to your requirement and then close the lid.

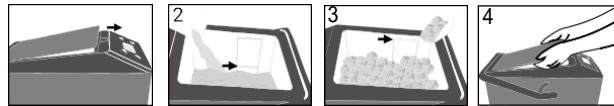

2. Apply the selected cuff
(Knee cuff as example, for other body parts please see the section Cuffs), Do not apply directly to skin, please add an isolation pad between the cuff and the skin.

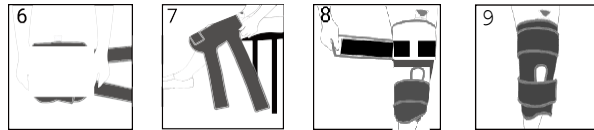

3. Connect the AC adaptor to the cooler, then plug the AC adaptor

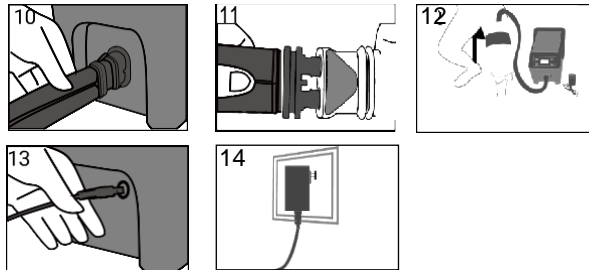

4. Press the Power button about 3-5 seconds, the screen should light up and show Welcome.

5. Press the or button to choose the mode/pressure.

| Mode | 1 | 2 | 3 | 4 | 5 | 6 | 7 | 8 | 9 |
|---------------|----|----|----|----|----|----|----|----|----|
| Pressure | | | | | | | | | |
| Time on(min) | 20 | 40 | 60 | 20 | 40 | 60 | 20 | 40 | 60 |
| Time off(min) | | | | | | | | | |

Remark

Mode: there are 9 modes in total, display shows which program user selected.
 Press: represents the water pressure of cuff from cooler in operation.
 Time on: working time of active cold compression application
 Time off: Pause time after completing selected working time, pause time and working time cycles till the device is turned off.

6. Press the Play/Pause button to start or stop the cooler.
 7. Press the Power button about 3-5 seconds to turn off the cooler.

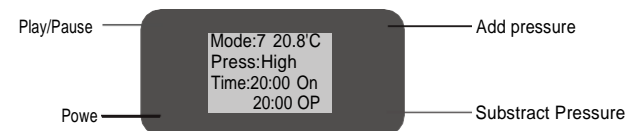

8. Finish using, unplug from power supply.
 Connect the drain gadget to cuff and drain water out; pour water out from cooler.



Troubleshooting

| Problem | Problem Description | Solutions |
|---|---|--|
| Missing accessory | Certain accessory such as adaptor or cuff was found missing. | Contact dealer (or manufacturer) to ship the missing item. |
| Shell Damaged | Collision, falling off or rough handling beyond fatigue limit may cause such damage. | 1. Bond with strong glue, tape, etc. 2. Replace the damaged structural component or return the product for repair. |
| Stains | Logistics, weather or other reasons may cause stains to carry bag and external parts | 1. Clean the bag, use damp towel to wipe device cover. 2. Replace the stained part. |
| Flashing screen or white screen | 1. After adaptor is plugged in, display flashes, no response to button pressing and machine cannot be turned on. 2. Machine is on and in normal operation while screen is white. | 1. Disconnect from power supply, restart the machine; or try another adaptor 2. Contact for repair or exchange. |
| Can not turn it on | After adaptor is plugged in, no response to button pressing and no display. | 1. Check if the power supply of socket or outlet is normal. 2. Check if the adaptor is damaged (use any port to match the adaptor of 12V-2A DC output to test). 3. Check if there is any damage on display or button area. Replace broken parts accordingly. 4. Contact for repair or exchange. |
| No water pressure, no water circulation | Machine is on and display is normal, but there is no water pressure nor water circulation when working. | 1. Machine is on, there is no water pressure nor circulation, but water pump is working and roaring. Then air exists inside pump, water can not be pumped due to atmospheric pressure. Shake the cooler, or press hose joint of cooler several times after hose disconnected from it, it will thus back to normal. 2. Machine is working, no water pressure or the pressure is too low, and circulation speed is slow; then check if the water inlet and outlet of water pump is blocked, get it cleaned. Check if cuff is overly folded to cause waterway clogged. 3. Machine is on, no water pressure nor circulation, and no sound is generated from equipment; then water pump is damaged and needs replacement. Contact for repair or exchange. |
| Water leakage | Water leaks at locations such as water outlet of cooler, hose or cuff | 1. Check if hose is properly connected with cooler and cuff; replace the leaking part. 2. Contact for repair or exchange. |
| Buzzer alarm | Water pump idling with water shortage; overcurrent or open circuit of water pump ; | 1. Check if water line is too low and add more water accordingly; 2. Check if the water inlet is blocked for normal water pumping, clear it. 3. Inspection and replacement of water pump assembly and circuit board may be needed ; Contact for customer service. |

Other Instructions

Shell-life: 3 years.

Storage Condition: The product should be stored in a cool, dry; well ventilated and clean environment without corrosive substance.

Cleaning & Disinfecting: Use soft cloth or towel to wipe to clean. Wipe the cooler surface with a cloth dipped in 75% alcohol or ethanol disinfectant.

Warning: No modification of this equipment is allowed.

Caution: Cooler must be turned off and disconnected from power mains (wall outlet) prior to cleaning or disinfection.

DISPOSAL: Do not discard the product in regular waste; The device and packaging must be disposed of in accordance with respective local or national environmental regulations.

Warranty Information

Equi recover warrants that the product, if properly used, will be free from defects in materials or workmanship for a limited period, cooler is warranted for one (1) year and cold cuff is 6 months after the date of original purchase.

If the product, which subjects to this Limited Warranty, malfunctions during the warranty period for reasons covered by this Limited Warranty, Equi recover, at its options, may elect to exchange or repair the returned product with either a new or reconditioned product. This limited warranty exists only to the original purchaser of the product and are non-transferable.

EXTENT OF LIMITED WARRANTY

This limited warranty does not cover damages due to external causes, including, without limitation, accident, usage not in accordance with product instructions, misuse, neglect, alteration, normal wear and tear or unauthorized repairs.



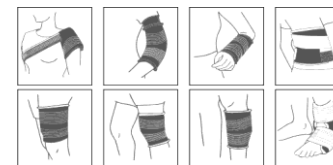
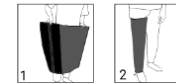
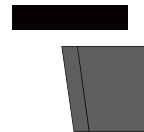
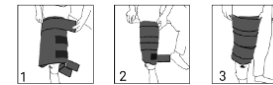
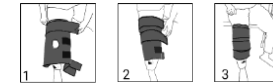
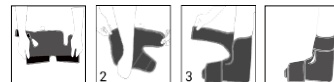
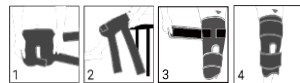
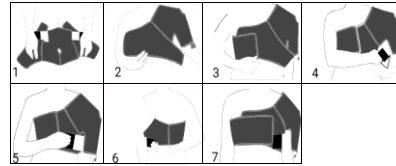



Cuffs



Standard Compliance

This device adheres to the following standards: IEC 60601-1:2005 ; EN 60601-1:2006; IEC 60601-1-11:2015; EN60601-1-11:2015; IEC60601-1-2:2014; EN60601-1-2:2015.

Symbol Index

| | | |
|--|--|---------------------------|
|  | Refer to instruction manual | |
|  | Serial number | Date of manufacture |
|  | Manufacturer | Medical Device |
|  | Do not use as a replacement part | Repair |
| | Direct current | " Keep away from sunlight |
| IP21 | Ingress Protection Marking of IP21: Protected from touch by hands greater than 12 millimeters, Protected from condensation. | |
|  | Disposal of product according to local regulations. | |
|  | Caution Symbol Indicates that important cautionary information, such as warnings and precautions, cannot be presented on the medical device itself and are presented in the instructions for use. | |

Warranty Registration Card

Warranty Registration Card

Please fill out and return upon purchase.

Your Name: _____

Phone No.: _____

Email Address: _____

Company/organization: _____

Purchase From: _____

Purchase Date: _____

Model No.: _____

Contact information

Equi recover

Opperduit 360

2941 AR Lekkerkerk

Netherlands

info@equirecover.com